

---

# COMMUNITY PARK

---





**DESCRIPTION**

The scope of the project was to elevate the quality of the existing park through improvements of its existing recreation elements of baseball fields, playground, open spaces, parking and vehicular access. In addition, the introduction of new program elements such as a new concession and restroom structure for the base-

ball fields, extensive lighted walking paths, park shelters, social spaces, site furnishings, interpretive information, foot bridges spanning a creek, and an overall improved unity and visual identity for the park. In the summer of 2014 major renovations were completed to Anna T Jordan community pool and bath house.

**PROJECT DATE**

2006	Design Phase
2006	Design Development Phase
02/23/2006	Public Input Meeting
01/23/2007	Oral History Public Meeting
12/19/2006	Commission Approval
01/23/2007	Oral History Public Meeting
2006 - 2007	Construction Documentation Phase
January 2007	Ground Breaking Ceremony
11/03/2007	Re-Grand Opening
Summer 2014	Pool Renovation



**PROJECT COST**

\$35,000	Design Phase
\$5,000	Design Development Phase
\$15,000	Maintenance Building
\$25,000	Construction Documentation Phase
\$1,910,000	Park Construction
\$370,480	Pool Renovation (Const. and Engineering)



# ANNA T. JORDAN COMMUNITY

BREC

## PROJECT SITE PLAN

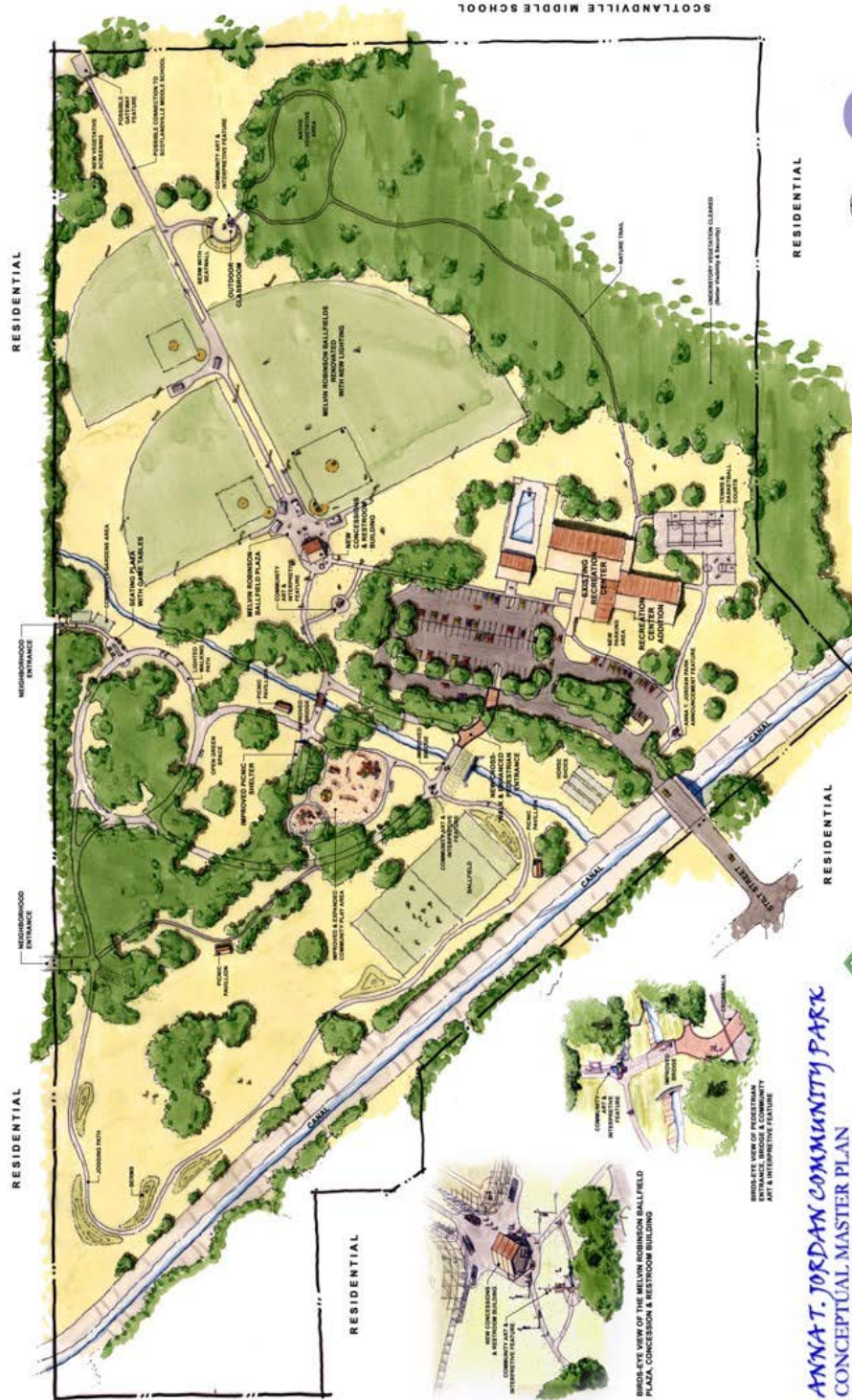

The above Conceptual Master Plan represents preliminary ideas for Anna T. Jordan Community Park. Some of these proposed features may be implemented in phases.

### ANNA T. JORDAN COMMUNITY PARK CONCEPTUAL MASTER PLAN



Ideas for Possible Improvements  
Master Plan Community Meeting - Feb. 23, 2006  
East Baton Rouge Parish Recreation & Park Commission  
BREC - Planning & Engineering Department





PROJECT PHOTOS



Site Prior to Improvements



New Pathways & Pedestrian Bridge



Site Prior to Improvements at Creek



New Pergola and Social space at Playground



Old Playground



New Playground





# ANNA T. JORDAN COMMUNITY PARK

BREC

## PROJECT PHOTOS



ANNA T. JORDAN COMMUNITY PARK



Pool & Bath House Improvements



Renovated Pool



Ball Fields Prior to Improvements



New Active Zone Plaza



Old Park Sign



New Park Monument Signage





**DESCRIPTION**

A conceptual master plan for BREC’s oldest and most historic park was completed in 2004 by Henslee-Cox, Landscape Architects. This plan was further developed by Carol R. Johnson Associates of Boston, a firm with expertise in historic urban parks and golf courses. CRJA completed a detailed analysis of the master plan while facilitating additional public workshops so that the final plan fit the vision and values of the community. The thorough analysis and

design development resulted in a new vision of this 153 acre historic park that has transformed the park into a very active and important part of the surrounding neighborhoods. The new improvements include a meandering promenade beneath old live oaks, fountains, outdoor gathering spaces, a new thematic playground, dog park, Labyrinth, renovated golf course and special details and materials honoring the park’s historic past.

**PROJECT DATE**

2004	Design Phase - Henslee Cox
01/27/2005	Public Input Meeting
03/22/2005	Commission Approved Conceptual Master Plan
2005 - 2006	Design Phase - Carol Johnson Associates
02/13/2006	Stakeholder & Public Input Meeting
2007 - 2008	Construction Documentation Phase
06/26/2007	Raising Cane’s Dog Park Ground Breaking
05/31/2008	Re-Grand Opening
July 2014	Pool Renovation



**PROJECT COST**

\$25,000	Master Plan
\$70,000	Gym/Pavilion Demolished/Abated
\$380,000	Construction Drawings
\$6,000,000	Construction
\$400,000	Brooks Design and Construction
\$35,000	Brooks Pool Facility Improvements
\$395,000	Pool Renovation



**DONATION RECEIVED**

Capital One	Donation towards Tennis Center Construction	\$125,000
Raising Cane’s	Donation towards Dog Park Construction	\$50,000





# CITY BROOKS COMMUNITY PARK

BREC

## PROJECT SITE PLAN

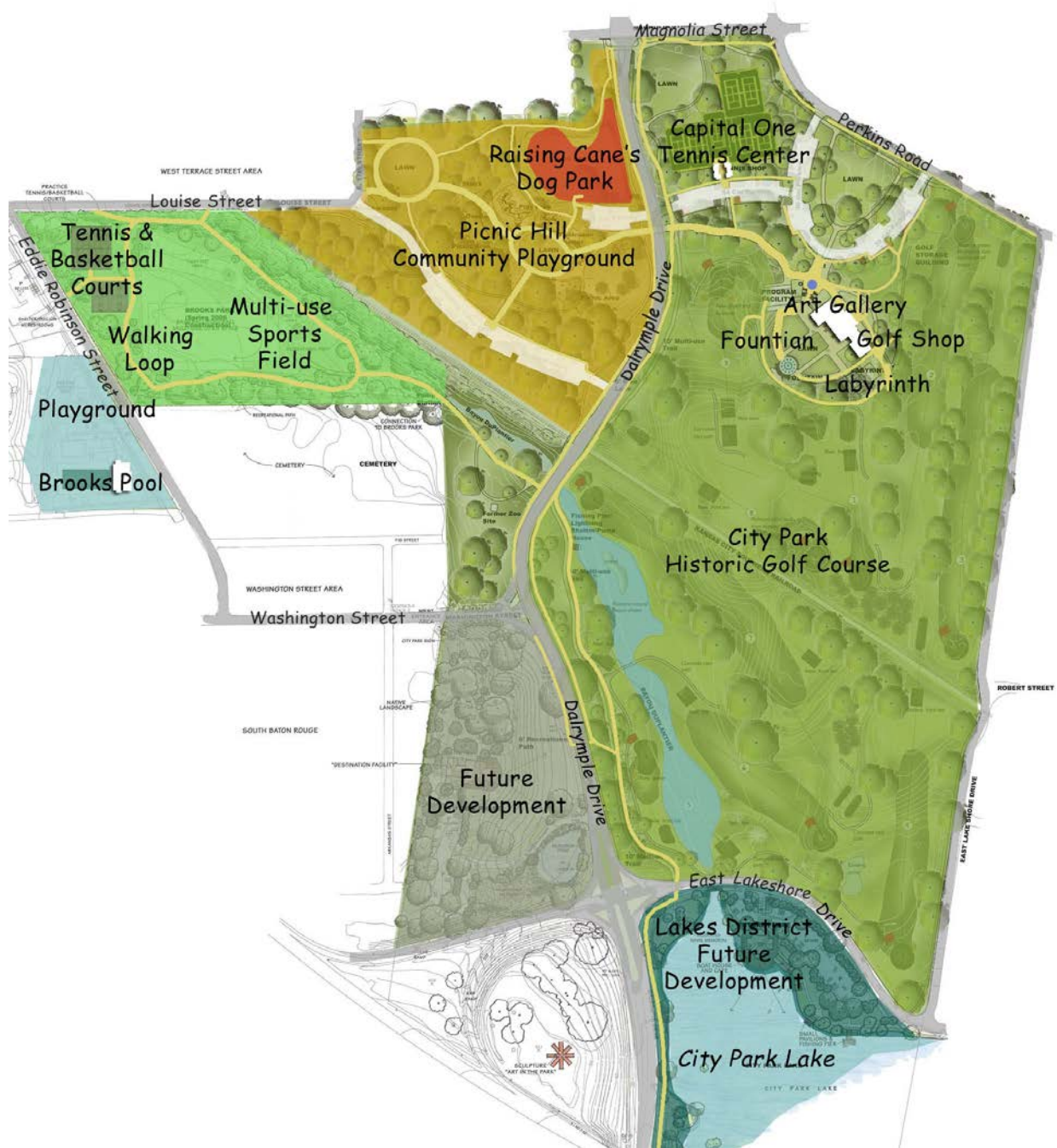



PROJECT PHOTOS



Tennis Courts & Center Prior to Improvements



New Capital One Tennis Center



City Tennis Courts Prior to Improvements



Refurbished Tennis Courts



Back of Art Gallery Prior to Improvements



New Event Space and Interactive Fountain Plaza





PROJECT PHOTOS



City Park Golf Course Under Construction



Renovated Golf Course



Picnic Hill Prior to Improvements



New Restroom Facility, Pathways & Benches



Picnic Hill Playground Prior to Improvements



New Playground with Safety Surface





**DESCRIPTION**

This 114-acre Community Park is 57 years old and is considered one of the community’s oldest recreation facilities. It is located in the southeastern part of East Baton Rouge Parish. The new renovation and improvements to the park include a new delightfully themed playground, new modern restroom facilities, new splash pad, eight refurbished tennis courts, three new tennis courts, a renovated tennis center, three renovated ball fields, a

new dog park, fishing pond and pier, lighted multi-use paths, seven picnic pavilions, upgraded recreation center and new environmentally sustainable parking lots. The park’s vehicular circulation system was redesigned to provide a more organized and user-friendly structure to the various park spaces and facilities. New way-finding signage and entry features provide a warm welcome to park users.

FOREST COMMUNITY PARK

**PROJECT DATE**

2006	Pilot Dog Park
05/31/2007	1st Public Planning Meeting
08/29/2007	2nd Public Planning Meeting
09/20/2007	Commission Approval
2009 - 2010	Site Improvements
10/23/2010	Re-Grand Opening

**PROJECT COST**

\$40,000	Pilot Dog Park
\$35,000	Master Plan
\$300,000	Construction Documents
\$900,000	New Maintenance Facility
\$75,000	Restroom Addition
\$4,000,000	Site Improvements
\$50,000	Recreation Center Partial Reroof
\$5,000	Maintenance Area Screening





# FOREST COMMUNITY PARK

BREC

## PROJECT SITE PLAN



PROJECT PHOTOS



Old Park Entrance



New Monument Signage at Park Entry

FOREST COMMUNITY PARK



Park Road Prior to Improvements



New Realigned Roadway



Old Maintenance Facility



New Maintenance Facility





PROJECT PHOTOS



Playground Prior to Improvements



New thematic Playground

FOREST COMMUNITY PARK



Tennis Courts Prior to Improvements



New Tennis Center Complex



Dog Park Prior to Improvements



New Raising Cane's Dog Park





PROJECT PHOTOS



Climbing Net at New Playground



New Splash Pad

FOREST COMMUNITY PARK



Ball Field Renovations



New Nature Trail



New Fishing Lake with Pier & Walking Trail



View of Lake from Pier



**DESCRIPTION**

**G**reenwood Community Park underwent a major transformation and re-opened to the public in October 2011 with vast improvements intended to serve the community at a higher level with recreational opportunities involving the entire family. Improvements include an 18 acre lake with fishing piers and boat slips, amphitheater, and ExxonMobil

Nature Trail; a new community playground and spray pad with restroom facilities for visitors; a new Raising Cane’s dog park; an 18 hole disc golf course, and a renovated tennis center. The park also features “The Waterfront” a new multi-use building housing the Dumas Pro Shop, Waterfront Café, and a large meeting room.

**PROJECT DATE**

2005	Design Phase
08/20/2007	Public Input Meeting
11/19/2007	Public Input Meeting
2006 - 2007	Design Development Phase
2007	Construction Drawings Phase I
07/26/2007	Dumas Memorial Golf Course Improvements
11/26/2007	Commission Approved Master Plan
07/21/2008	Ground Breaking
2008 - 2010	Construction Drawings Phase II
10/16/2010	Re-Grand Opening



**PROJECT COST**

\$35,000	Master Plan
\$482,000	Construction Drawings
\$30,000	Dumas Memorial Golf Course Design
\$675,000	Dumas Memorial Golf Course Construction Ph I
\$3,950,000	Multi-Purpose Bldg Construction
\$3,400,000	Site Improvements
\$100,000	Hwy 19 Multi-Use Connector Trail







PROJECT PHOTOS



New Lake Front Amphitheater



"The Waterfront"

GREENWOOD COMMUNITY PARK



Dumas Pro Shop Prior to Improvements



New Dumas Pro Shop at The Waterfront



Tennis Center Before



Tennis Center Completely Remodeled





PROJECT PHOTOS



New Boardwalk Along Lake



New ExxonMobil Nature Trail



New Spray Pad



New Community Playground



New Entrance to Tennis Center



New Raising Cane's Dog Park





## DESCRIPTION

Highland Road Park is in the midst of a transformation into a Community Park. The park has remained open to the public during construction phases. Phase I is complete with renovations and additions to the parking lots near the Recreation Center and also near the ball fields along Highland Road. Five additional tennis courts were built and 14 existing courts were refurbished. Phase II

included the construction of a new parking lot along Amiss Road, a 2/3 mile walking path with benches, exercise station, a Grand Pavilion with the Great Lawn, and a promenade with benches and landscaping. Phase III includes a new community playground, spray pad and renovations to the recreation Center.

## PROJECT DATE

2006	Observatory Telescope Building
2007	Master Plan
2009	5 New Tennis Courts & Court Improvements
2011	Phase I: Parking lot Renovations
2012	Phase II: Parking Lot, Walking Path, Sun Dial, Grand Lawn
2013	Grand Pavilion
2013	New Siding on Observatory
2014	Tennis Center Renovations
2014-2015	Phase III: Playground & Splash Pad



## PROJECT COST

\$75,000	Observatory Telescope Building
\$10,000	Master Plan
\$370,000	5 New tennis Courts
\$128,000	Tennis Court Improvements
\$1,200,000	Phase I: Parking lot renovations
\$1,270,000	Phase II: Parking Lot, Walking Path, Sun Dial, Grand Lawn
\$450,000	Grand Pavilion
\$20,000	New Siding on Observatory
\$30,000	Tennis Center Renovations
\$2,200,000	Phase III: Playground & Splash Pad





# HIGHLAND ROAD COMMUNITY PARK

BREC

## PROJECT SITE PLAN





# HIGHLAND ROAD COMMUNITY PARK

BREC

## PROJECT PHOTOS



HIGHLAND ROAD COMMUNITY PARK



Gravel Parking Lots Near Ball Fields Before



New Paved Parking



Gravel Parking Lots Near Recreation Center Before



Additional Paved Parking



New Pilaster & Parking Lot



Observatory Telescope Building





PROJECT PHOTOS



Tennis Courts Before



Tennis Courts After Renovations



Phase II Grand Pavilion



Phase II Grand Pavilion



Phase II Sun Dial Plaza



Phase II Plaza & Crush Stone Path





**DESCRIPTION**

Howell Community Park underwent a major transformation and re-opened to the public in October 2009 with vast improvements intended to serve the community at a higher level with recreational opportunities involving the entire family. Improvements include new asphalt paved parking areas, extensive concrete walks and plazas and architectural site lighting. The ball

field and tennis courts were renovated and sand volleyball was added and a new concession building was built along with new architectural picnic shelters. Children of all ages are having a great time exploring the new celestial-themed community playground complete with rubber safety surfacing and site furnishings.

HOWELL COMMUNITY PARK

**PROJECT DATE**

- 2006 Design Phase
- 06/22/2006 Public Input Meeting
- 2007 Design Development Phase
- 11/26/2008 Commission Approved Master Plan
- 2008 Construction Drawings
- 07/21/2008 Ground Breaking
- 10/03/2009 Re-Grand Opening
- 2012-2013 Pool Renovation

**PROJECT COST**

- \$15,000 Master Plan
- \$25,000 Construction Drawings
- \$2,700,000 Park Improvements
- \$410,000 Pool Renovation





# HOWELL COMMUNITY PARK

BREC

## PROJECT SITE PLAN





PROJECT PHOTOS



Playground Before



New celestial-themed community playground

HOWELL COMMUNITY PARK



Tennis Courts Prior to Improvements



Resurfaced Tennis Courts



Concession Building Before



New Concession Building & Ball Field





# HOWELL COMMUNITY PARK

BREC

## PROJECT PHOTOS



Celestial-Themed Playground with Rubber Surface



New Picnic Shelters & Site Furnishings



New Fitness Station



New Pedestrian Bridge



New Walking Paths & Landscaping



New Signage

HOWELL COMMUNITY PARK





**DESCRIPTION**

Independence Community Park improvements include the construction of the new Liberty Lagoon Family Aquatic Center, a new Iris pavilion with new garden arbors tucked into the Iris Garden, improved parking throughout the park and a 12 ft. wide, half-mile crushed stone path along Independence Boulevard that will eventually be extended as a 1.3 mile loop

around the entire south side of the park. The new Main EBRP Library now features an outdoor plaza that will serve as an inviting social space and organize connections to the surrounding library, BREC's Café and Teaching Garden Building and to Independence Botanical Gardens.

**PROJECT DATE**

2007 - Present	Design Phase
03/22/2007	1st Public Input Meeting
06/14/2007	2nd Public Input Meeting
2010	New Iris Pavilion & Arbors
2010	Phase I Trail Construction
05/25/2011	Liberty Lagoon Grand Opening
2011	Parking Improvements Phase I & II
2008 - 2014	The Library Design Collaborative
2015	Parking Improvements Phase III

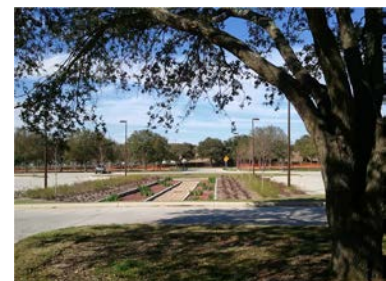

**PROJECT COST**

\$35,000	Master Plan
\$30,000	Sensory Garden Improvements
\$100,000	Iris Garden Pavilion & Arbors
\$20,000	Design of Spaces with Library
\$450,000	Aquatic Center Design
\$6,700,000	Aquatic Center Construction
\$1,650,000	Parking Improvements Phase I & II
\$1,500,000	Library in the Park
\$200,000	Phase I Trail Construction
\$2,000,000	Café and Teaching Garden Building





# INDEPENDENCE COMMUNITY PARK

BREC

## PROJECT SITE PLAN



LIBERTY LAGOON AT INDEPENDENCE COMMUNITY PARK



INDEPENDENCE COMMUNITY PARK MASTER PLAN





PROJECT PHOTOS



Iris Garden Before Improvements



Iris Garden With New Arbors & Seating



New Iris Pavilion At Botanic Garden



Iris Flower Etched In Concrete At Iris Pavilion



Site Prior To Trail Development



Phase I Jogging and Walking Trail





PROJECT PHOTOS



Liberty Lagoon Family Aquatic Center



Water Playground Is Just One Of Many Features



New Paved Parking With Lights & Rain Garden



New Café and Teaching Garden Building



New Botanical Garden Propagation Areas



New Parking Near Sports Fields



## DESCRIPTION

Jackson Community Park is undergoing a master planning process for park renovations. In 2012, two public planning meetings were held for Jackson Park. During one planning meeting, it was determined that Jackson Park would be the community park

in the City of Central. At the other, a conceptual master plan was presented to the public showing potential site enhancements throughout the park and to gain insight for the preferred location of a new splash pad.

## PROJECT DATE

2012	Design Phase
11/01/2012	Public Input Meeting
12/07/2012	Public Input Meeting
2013	Design development –Splash Pad
2014	Splash pad Construction
Beyond 2014	Master Plan Implementation

## PROJECT COST

\$5,000	Design Phase
\$25,000	Design Development Phase
\$500,000	Splash Pad
\$?????	Future development—Master Plan





# JACKSON COMMUNITY PARK

BREC

## PROJECT SITE PLAN



### LEGEND

- 1 PLAYGROUND
- 2 SPLASH PAD
- 3 ENTRY PLAZA
- 4 RECREATION CENTER
- 5 PICNIC SHELTER
- 6 TENNIS COURTS
- 7 ASPHALT PARKING LOT
- 8 WALKING PATH
- 9 SEATING AREA
- 10 JACKSON MOUNUMENT
- 11 DROP OFF AREA
- 12 RESTROOM

JACKSON COMMUNITY PARK  
PROPOSED MASTER PLAN A

## JACKSON COMMUNITY PARK



### NEWLY PROPOSED SITE ELEMENTS

- 1 SPLASH PAD
- 2 PLAYGROUND
- 3 RESTROOM/ PUMP HOUSE

### EXISTING SITE ELEMENTS

- 4 TENNIS COURTS
- 5 BASKETBALL COURTS
- 6 RECREATION CENTER
- 7 BASEBALL FIELD
- 8 PICNIC SHELTER

JACKSON COMMUNITY PARK  
SPLASH PAD AND TEMPORARY PLAY GROUND

## JACKSON COMMUNITY PARK



# JACKSON COMMUNITY PARK

BREC

## PROJECT PHOTOS



Jackson Park Monument



Existing Playground



Swings



Recreation Center



Parking Lot



Park Entry Sign

JACKSON COMMUNITY PARK







## DESCRIPTION

Jackson Community Park is undergoing a master planning process for park renovations. In 2012, two public planning meetings were held for Jackson Park. During one planning meeting, it was determined that Jackson Park would be the community park

in the City of Central. At the other, a conceptual master plan was presented to the public showing potential site enhancements throughout the park and to gain insight for the preferred location of a new splash pad. Construction

## PROJECT DATE

2012	Design Phase
11/01/2012	Public Input Meeting
12/07/2012	Public Input Meeting
2013	Design development –Splash Pad
2014	New Playground
2014-2015	Splash pad Construction
Beyond 2014	Master Plan Implementation

## PROJECT COST

\$5,000	Design Phase
\$25,000	Design Development Phase
\$500,000	Splash Pad and Playground



# JACKSON COMMUNITY PARK

BREC

## PROJECT SITE PLAN



### LEGEND

- 1 PLAYGROUND
- 2 SPLASH PAD
- 3 ENTRY PLAZA
- 4 RECREATION CENTER
- 5 PICNIC SHELTER
- 6 TENNIS COURTS
- 7 ASPHALT PARKING LOT
- 8 WALKING PATH
- 9 SEATING AREA
- 10 JACKSON MOUNUMENT
- 11 DROP OFF AREA
- 12 RESTROOM

JACKSON COMMUNITY PARK  
PROPOSED MASTER PLAN A

## JACKSON COMMUNITY PARK



### NEWLY PROPOSED SITE ELEMENTS

- 1 SPLASH PAD
- 2 PLAYGROUND
- 3 RESTROOM/ PUMP HOUSE

### EXISTING SITE ELEMENTS

- 4 TENNIS COURTS
- 5 BASKETBALL COURTS
- 6 RECREATION CENTER
- 7 BASEBALL FIELD
- 8 PICNIC SHELTER

JACKSON COMMUNITY PARK  
SPLASH PAD AND TEMPORARY PLAY GROUND

## JACKSON COMMUNITY PARK





PROJECT PHOTOS



Jackson Park Monument



Existing Recreation Center

JACKSON COMMUNITY PARK



Existing Playground



New Playground



# NORTH SHERWOOD FOREST COMMUNITY PARK BREC



## DESCRIPTION

The redevelopment of this project has spanned many years. Improvements include a renovated Family Recreation Center featuring an indoor track, playground, theater, kitchen, fitness center, aerobics room and an interactive “virtual” park. Outdoor improvements include a new asphalt driveway and parking lots, site

lighting. The removal of the former BREC Administration Building made way for a new basketball court, pavilion, plaza and additional parking. Current design work is focused on the development of a new community playground, splash pad, walking trail and lake improvements.

NSF COMMUNITY PARK

## PROJECT DATE

2004	Master Plan
Nov 2004	Public Input Meeting
2005	Recreation Center Renovations
2010 - 2011	Design Development Phase
Nov 2011	Recreation Center Re-roofing
2011 - 2012	Site Infrastructure Construction
Spring 2012	Administration Building Demolition
Summer 2013	Basketball Court and Parking
2014	Tree Planting



## PROJECT COST

\$5,000	Master Plan Phase
\$885,000	Recreation Center Renovations
\$165,000	Maintenance Buildings
\$125,000	Construction Documentation
\$1,850,000	Site Infrastructure Construction
\$390,000	Recreation Center Re-roofing
\$70,000	Administration Building Demolition
\$330,000	Basketball Court and Parking
\$22,495	Tree Planting





# NORTH SHERWOOD FOREST COMMUNITY PARK

BREC

## PROJECT SITE PLAN



PROJECT PHOTOS



Recreation Center Improvements



Indoor Playground

NSF COMMUNITY PARK

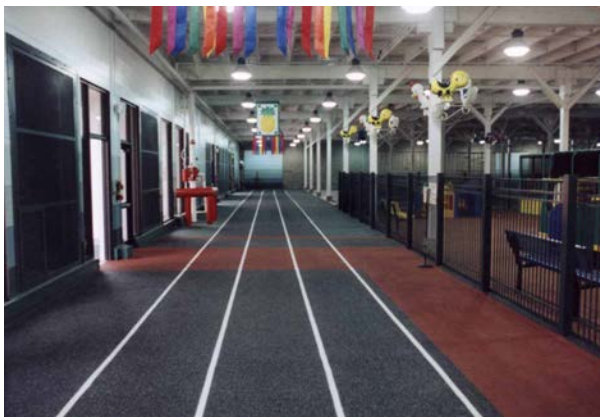

Indoor Track



Virtual Park



Virtual Park



Virtual Park





# NORTH SHERWOOD FOREST COMMUNITY PARK

BREC

## PROJECT PHOTOS



Parking Lot Prior to Improvements



New Asphalt Parking



Former Administration Building



Redeveloped Site with Pavilion



New Basketball Court



New Promenade

NSF COMMUNITY PARK





**DESCRIPTION**

This 52-acre Community Park is one of nine existing neighborhood parks that were transformed into a Community Park as part of BREC’s “Imagine Your Parks” plan passed by EBR Parish voters in 2004. Because the design for each Community Park evolves from public input, each one takes on a personality that reflects the needs of that particular community. Perkins has become known as BREC’s “Extreme Sports Park” because its venues are focused

primarily toward kids, teens and young adults. The park’s venues include a new state-of-the-art skate park, climbing wall, a renovated BMX Track, an “extreme” themed playground, a velodrome and outdoor sand volleyball courts. The park also features a new one-acre lake for paddling and fishing, four picnic shelters, resurfaced tennis courts, a sand volleyball court, a new toddler play area, and an extensive network of multi-use paths.

**PROJECT DATE**

2006	Master Plan Phase
2006	Public Input Meeting
02/23/2006	Design Development
01/23/2007	Public Meeting
12/19/2006	Commission Approval
01/23/2007	Public Meeting
2006 - 2007	Construction Documentation Phase
January 2007	Ground Breaking Ceremony
10/16/2010	Re-Grand Opening
10/16/2010	Re-Grand Opening
2014	New Shade Structure For Playground

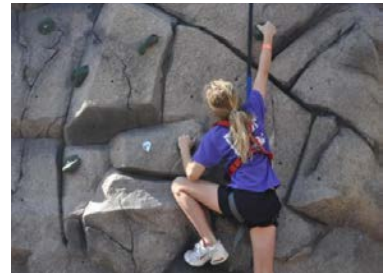

**PROJECT COST**

\$40,000	Master Plan
\$160,000	Wastewater Improvements
\$220,000	Construction Drawings
\$4,900,000	Site Improvements
\$165,000	Toddler Playground
\$245,000	Additional Parking for Sportsplex
\$25,000	Volleyball Court
\$25,000	Olympia Stadium Concession/Access
\$35,000 Grant from LSO Foundation for	Playground Shade Structure





# PERKINS ROAD COMMUNITY PARK

BREC

## PROJECT SITE PLAN



# PERKINS ROAD COMMUNITY PARK

BREC

## PROJECT PHOTOS



PERKINS ROAD COMMUNITY PARK



BMX Start Gate Prior to Construction



BMX Finish and Start Gate After Construction



Aerial View Prior to Construction



Aerial View After Construction



Open, Unused Space Prior to Construction



Open Space After Construction





PROJECT PHOTOS



New and Improved BMX Track



“Extreme” Playground



Improvements to Velodrome



The New Climbing Tower Plaza



Extreme Park “Branding” Signage



Skate Park Near Completion





**DESCRIPTION**

**B**REC "Imagine Your Parks" Strategic Plan called for a Community-Level park to be placed in the Northeast portion of East Baton Rouge Parish. After an intensive land study, BREC acquired approximately 400 acres on March 11, 2011 from several landowners in the northeast part of Parish. This land acquisition was the final Community Park site that BREC needed to acquire for the Imagine Your Parks Plan.

Sandy Creek Community Park will serve the northeast portion of the parish, but will have a regional draw. Ideas for the park include an equestrian theme, complete with horse trails, and a community playground and trails for mountain bike riding. Other amenities will be determined with public input during the master planning process.

**PROGRESS REPORT**

2010—2011	Land Study
March 2011	Land Acquisition
2012	Road Repair and New Parking Area
2014	Preliminary Trailhead and Trail Markers
Present	Design Development Phase



**PROJECT COST**

\$1,072,000	Land Acquisition
\$ 40,000	Road Repair and New Parking Area
\$ 30,000	Site Improvements

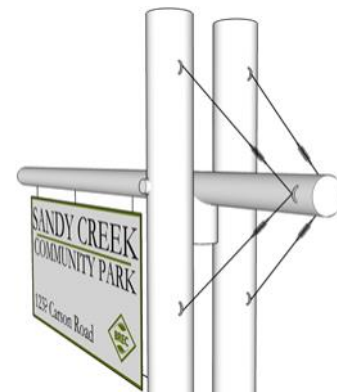



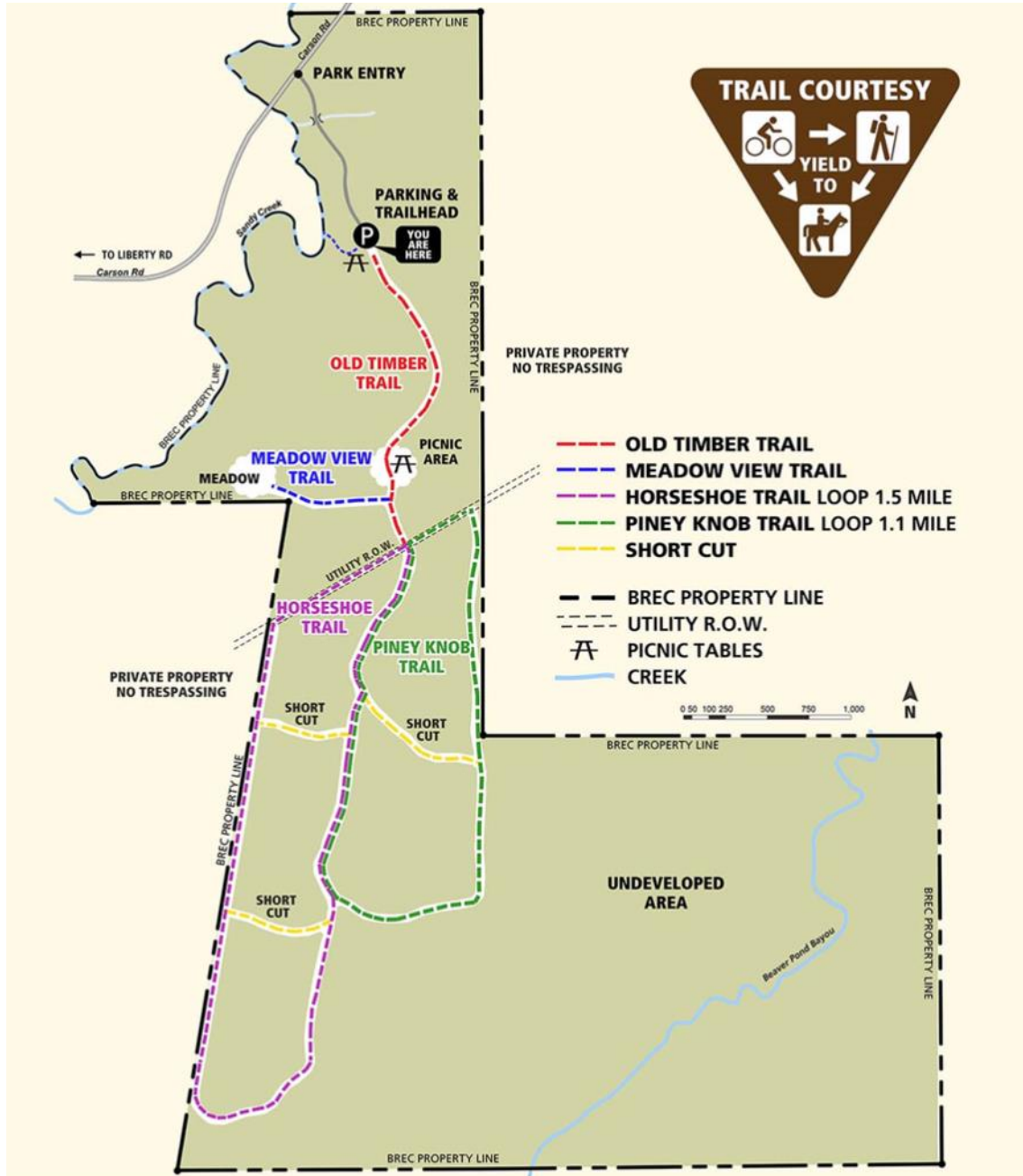

# SANDY CREEK COMMUNITY PARK

## PROJECT PHOTOS



View of Sandy Creek



New Parking Area



New Trail Signage



Equestrian Trails

SANDY CREEK COMMUNITY PARK







## DESCRIPTION

Land was acquired next to the existing Zachary Youth Park in 2005 for the development of Zachary Community Park. The former agricultural land has been re-shaped to create a park for the whole family. The first phase of construction includes an entry drive, parking lots, basketball and sand volleyball courts, a dog park, fishing pond, restroom building, signage, extensive walking paths, picnic shelters, site furnis-

ings, and site lighting. Next a modular skate park and a fishing pier were installed. The third phase included two plazas, a park building with a meeting room, restrooms, and equipment storage. In 2013, 15 acres of additional land was purchased for future growth totaling 50 acres for this Community Park. Next to be completed will be a community playground and splash pad.

ZACHARY COMMUNITY PARK

## PROJECT DATE

2005	Land Acquisition
2006	Master Planning Phase
12/12/2007	1st Public Input Meeting
04/29/2008	2nd Public Input Meeting
05/22/2008	Commission Approval
2008 - 2009	Construction Documentation Phase
2009 - 2010	Infrastructure Construction
Fall 2010	Skate Park and Pier Construction
2011—2012	Park Building and Plaza Construction
January 2013	Land Acquisition Phase 2
2013-2015	Playground and Splash Pad Design
2014	Tree Planting



## PROJECT COST

\$585,000	Land Acquisition
\$5,000	Master Plan Phase
\$100,000	Construction Documentation
\$2,450,000	Site Infrastructure Phase
\$165,000	Skate Park and Pier Construction
\$500,000	Park Building and Plaza Construction
\$ 20,000	Playground and Splash Pad Design
\$ 200,000	Land Acquisition Phase 2
\$ 28,057	Tree Planting



# ZACHARY COMMUNITY PARK

BREC

## PROJECT SITE PLAN



# Zachary Community Park MASTER PLAN



May 22, 2008

BREC Planning and Engineering





# ZACHARY COMMUNITY PARK

BREC

## PROJECT PHOTOS



Monument Sign at Park Entrance



Paved Parking Lot with Lighting

ZACHARY COMMUNITY PARK



Youth Park Ball Field Improvements



New Pier at Small Fishing Pond



Pavilion Rental



2013 Outdoor Recreation Festival



# ZACHARY COMMUNITY PARK

BREC

## PROJECT PHOTOS



View of Park Building



View of Lake from Meeting Room

ZACHARY COMMUNITY PARK



Wayfinding Signage & Pathways



New Pier With Seating at Large Fishing Pond



Raising Canes Dog Park



Skate Park

